

MOUNTAIN BIKE BAG PRO
BIKE BAG PRO

INSTRUCTION MANUAL

V04/KL/01-25

ENCLOSED PARTS BIKE BAG PRO // MOUNTAIN BIKE BAG PRO

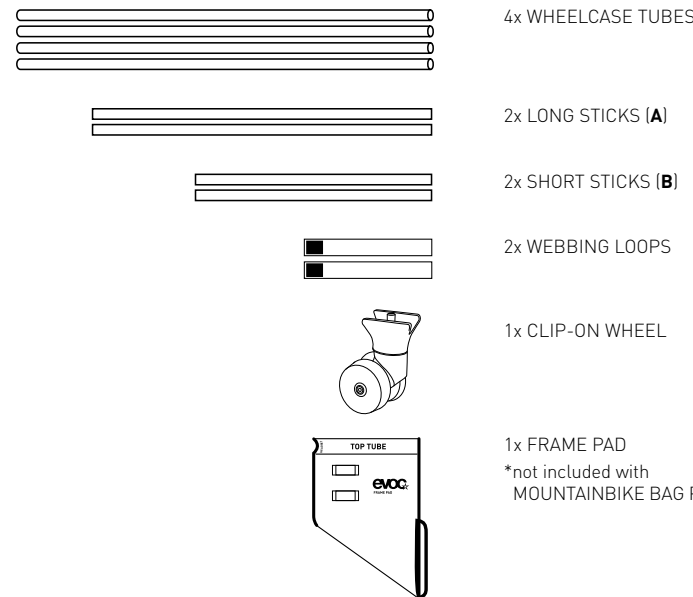

ENCLOSED PARTS BIKE STAND

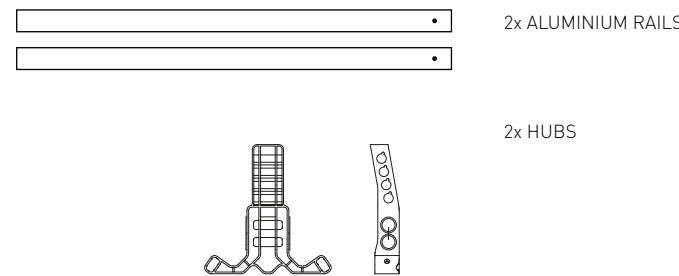

TOOLS NEEDED

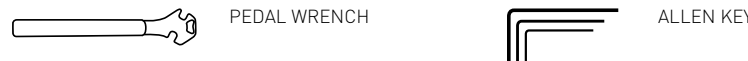

ENCLOSED PARTS BIKE STAND

10x LOWER AXLE ADAPTERS:

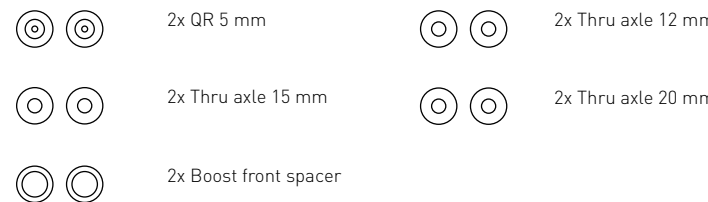

6x UPPER AXLE ADAPTERS:

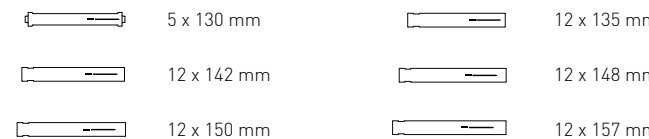

BIKE BAG PRO AND BIKE STAND PRO

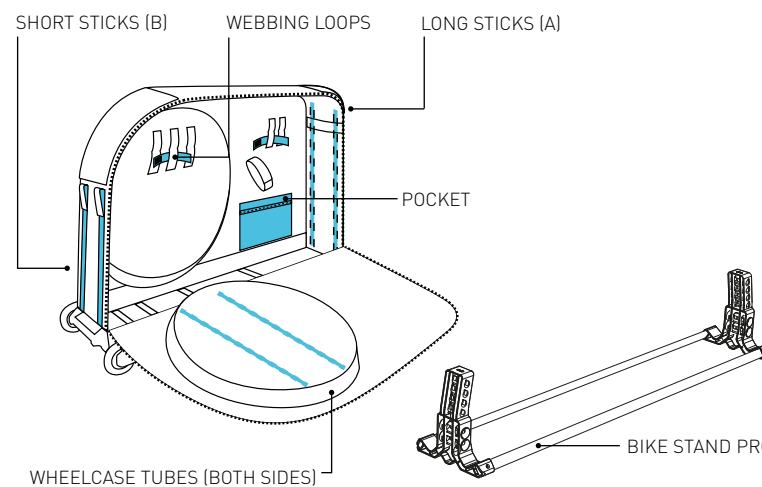

WATCH THE INSTRUCTION VIDEO



INSTRUCTION VIDEO
BIKE BAG PRO



INSTRUCTION VIDEO
MOUNTAIN BIKE BAG PRO

HOW TO ASSEMBLE YOUR BIKE BAG PRO OR MOUNTAIN BIKE BAG PRO

// 01

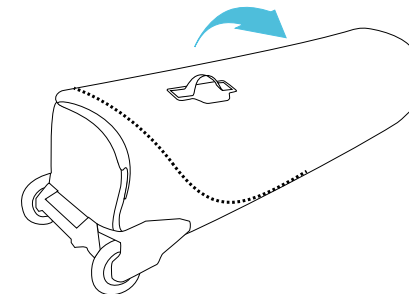

// 02 a (BIKE BAG PRO)

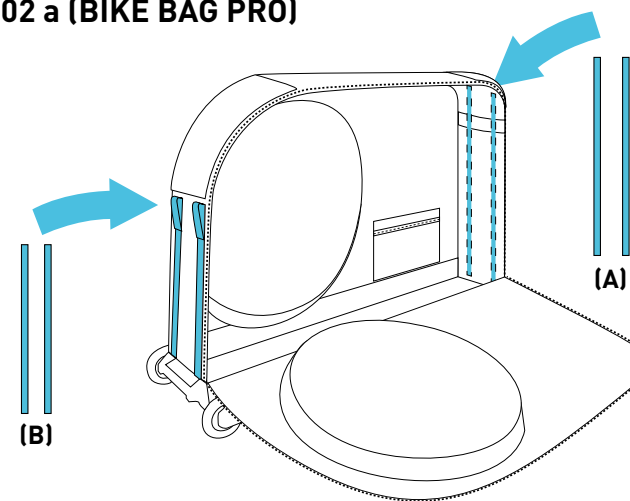

// 02 b (MOUNTAIN BIKE BAG PRO)

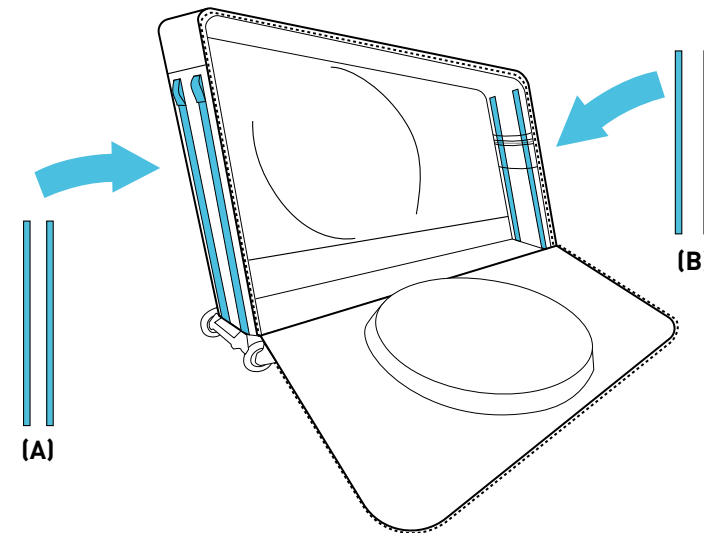

// 03

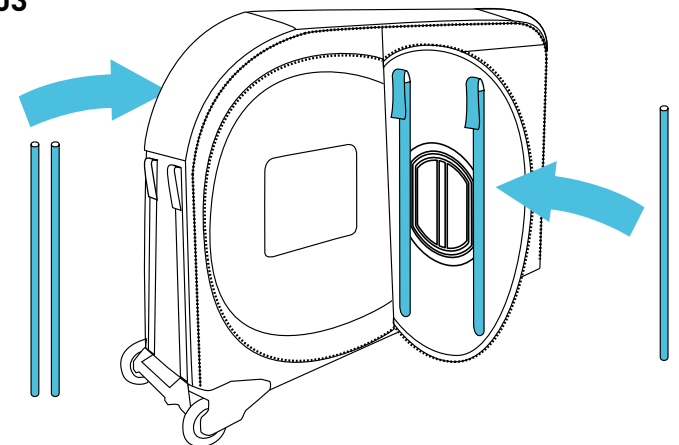

HOW TO ASSEMBLE YOUR BIKE STAND PRO

// 04

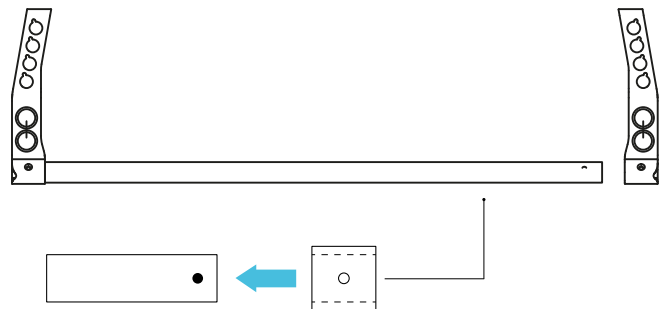

BIKE PREPARATION

// 05

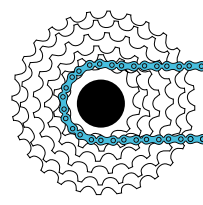

Chain on smallest sprocket

// 06

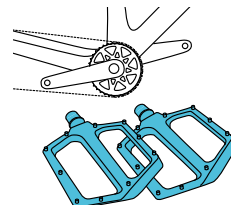

Remove both pedals

// 07

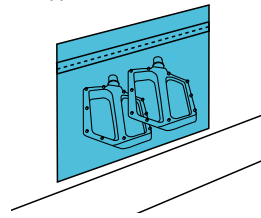

Put pedals in pocket

// 08

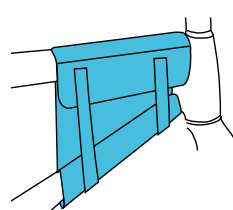

Add FRAME PAD (not necessary for MOUNTAIN BIKE BAG PRO)

// 09

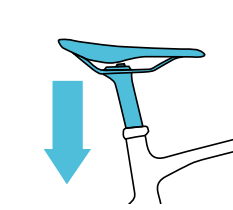

Lower your bicycle saddle

// 10

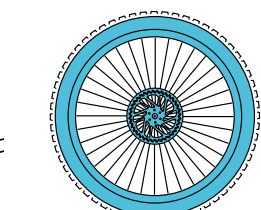

Remove front wheel

MOUNTING YOUR BIKE ON BIKE STAND PRO

// 11

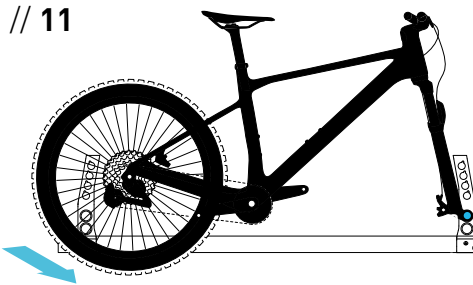

b) lower level for fork, two possible positions

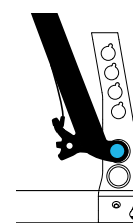

fix the fork to BIKE STAND at the two positions of the lower level (b). Use provided plugs according to your axle standard.

// 12

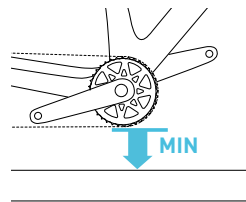
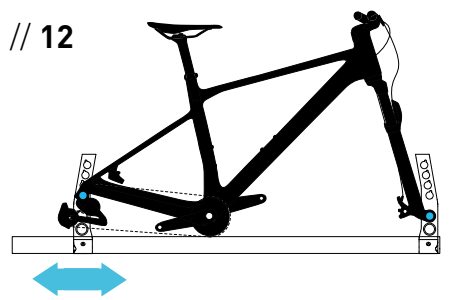

Adjust position of rear hub according to your wheel base. Place rear drop-outs on rear hub with correct upper axle adapter. Tighten your rear axel. Always choose lowest possible level at rear hub according to chain wheel size.

ADJUST HANDLE BAR

// 13 a (BIKE BAG PRO)

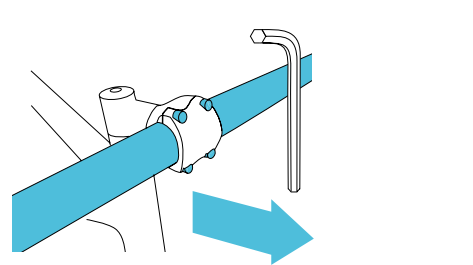

Remove handle bar and fix it on FRAME PAD

ADJUST HANDLE BAR

// 13 b (MOUNTAIN BIKE BAG PRO)

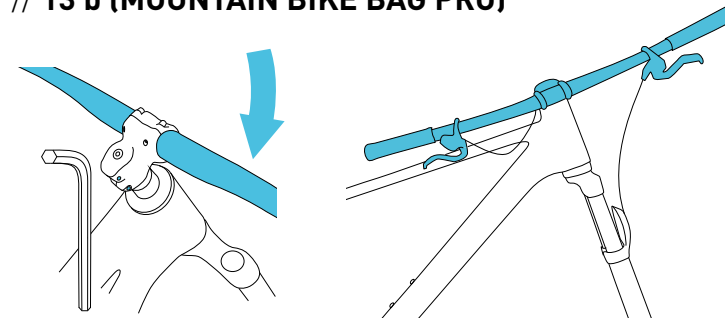

untighten screws on stem/fork connection and turn handle bar 90° clock-wise.

PLACE YOUR BIKE IN THE BIKE BAG PRO // MOUNTAIN BIKE BAG PRO

// 14 a (BIKE BAG PRO)

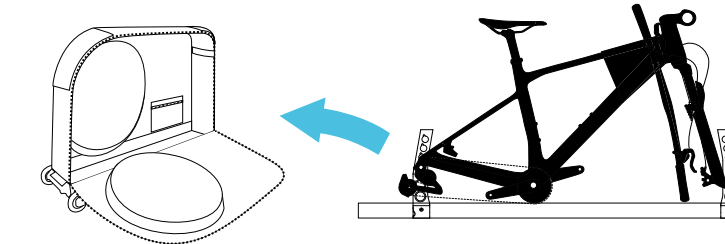

// 14 b (MOUNTAIN BIKE BAG PRO)

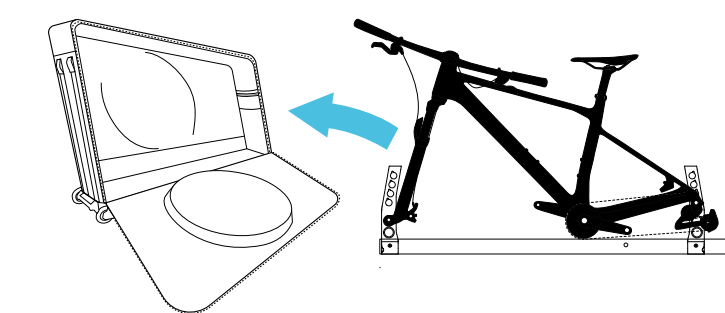

FIX YOUR BIKE WITH RED STRAPS

// 15 a (BIKE BAG PRO)

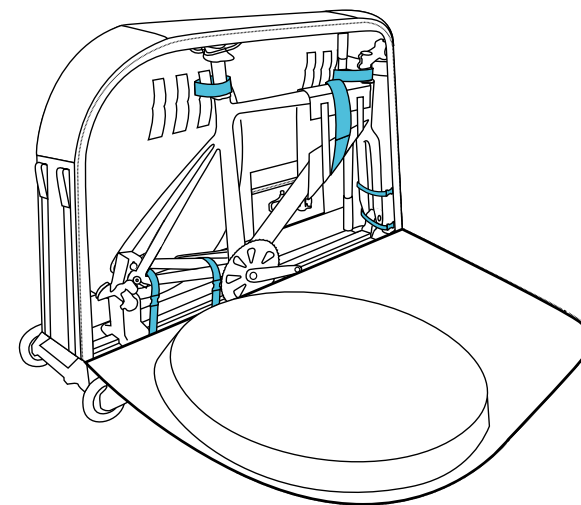

// 15 b (MOUNTAIN BIKE BAG PRO)

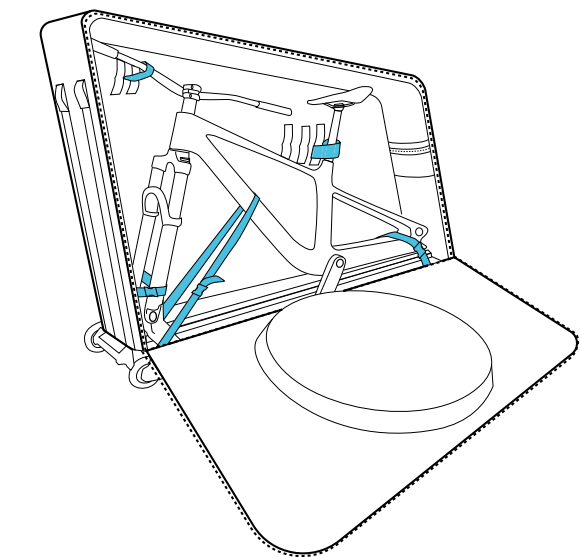

DON'T FORGET TO PUT WHEELS IN WHEEL COMPARTMENT

// 16

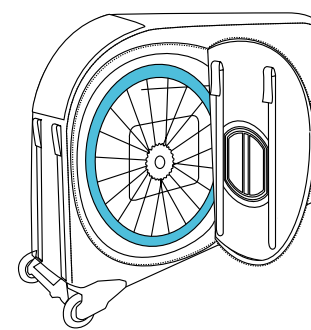

HOW TO USE THE CLIP-ON WHEEL

// 17

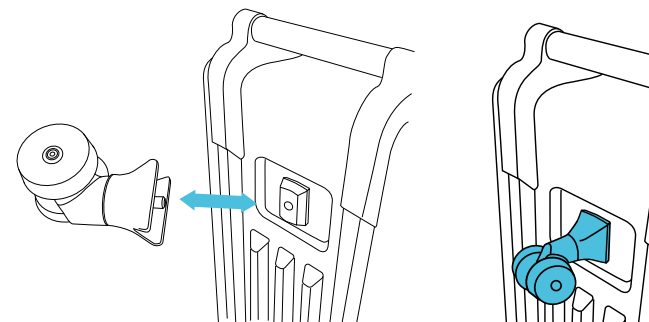

Click CLIP-ON WHEEL to counterpart on the front of bottom. Pin has to go into feed holes.

Remove CLIP-ON WHEEL before luggage drop and put back into BIKE BAG PRO or MOUNTAIN BIKE BAG PRO!

WARRANTY AND AFTER SALES SERVICE



WARRANTY
www.evocsports.com/service/warranty